

WASHINGTON

KALAMA

OREGON

GOBLE

WASHINGTON

OREGON

WASHINGTON

OREGON


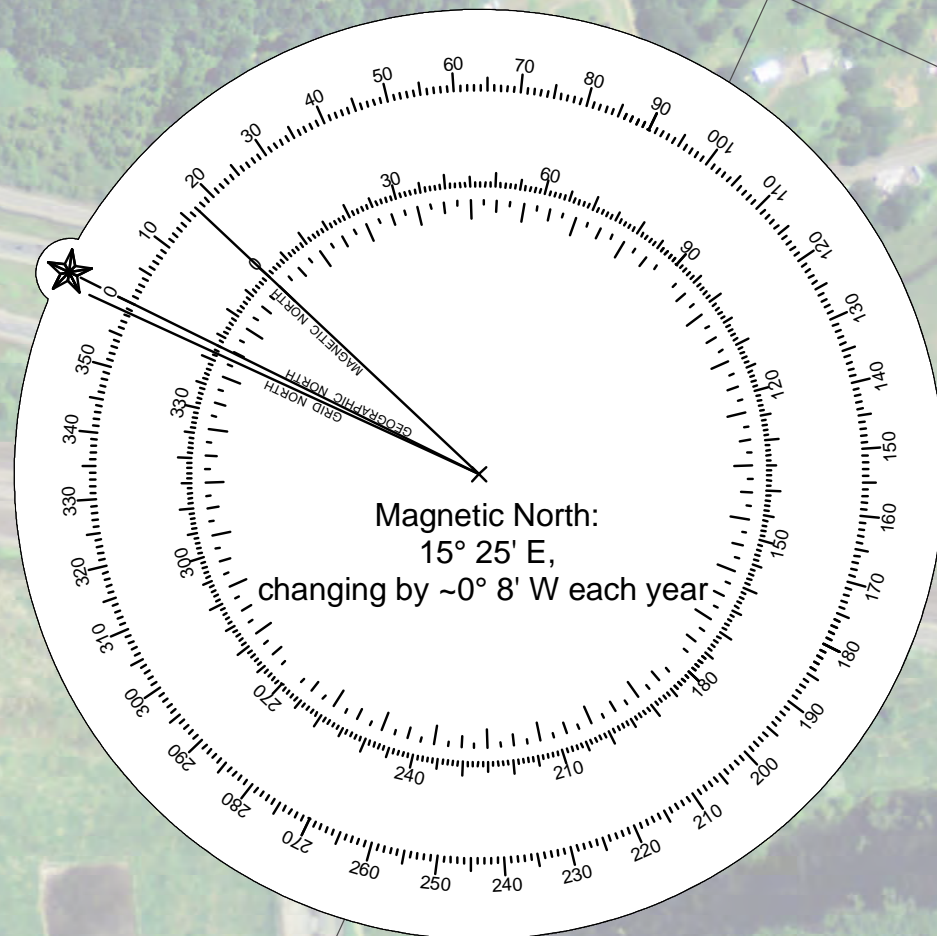

NOTES:
 Horizontal Coordinate System:
 North American Datum of 1983 (NAD83), projected to the State Plane Coordinate System (SPCS), Oregon North Zone. Distance units in U.S. Survey Feet.
 Vertical Datum:
 Soundings are shown in feet and indicate depths below Columbia River Datum. CRD is 3.20 feet above the North American Vertical Datum of 1988 (NAVD 88 Geoid 09) at Columbia River Mile 73.1, 3.33 feet above at River Mile 75.1.
 River mileage conforms to the River Mile Index of the Hydrology and Hydraulics Committee, Pacific Northwest River Basins Commission, July 1972.
 The information depicted on this map represents the results of a survey conducted on the date indicated and can only be considered to represent the general channel conditions existing at that time and is in support of channel maintenance only.
 ** Shoalest Sounding per Quarter per Reach

LEGEND	
	Buoy, Lateral
	Buoy, Cardinal
	Buoy, Isolated Danger
	Buoy, Safe Water
	Buoy, Special Purpose
	Beacon, General
	Benchmark
	Pylon Bridge Support
	Rock
	Obstruction Point
	Wreck-Submerged
	Staff Gage
	Recording Gage
	Steel King Pile
	Shoalest Sounding**

COLUMBIA AND LOWER WILLAMETTE RIVERS
 BELOW VANCOUVER, WASH. AND PORTLAND, OREG.
COLUMBIA RIVER
KALAMA RANGES
 26 December 2024
 SCALE IN FEET
 0 500 1,000 1,500 2,000 2,500
 SUBMITTED: _____ APPROVED: _____
 RECOMMENDED: _____ CHIEF, WATERWAYS MAINTENANCE SECTION
 CHIEF, SURVEY SECTION _____ SURVEYED: _____ PLOTTED: _____ CHECKED: _____
 CL_20_KLM_20241226_CS

THE EXISTING PROJECT
 The existing project provides for a channel 43 feet deep and 600 feet wide from deep water in the Columbia River Entrance at river mile 3.0 to river mile 101.4 at the Mouth of the Willamette River.